

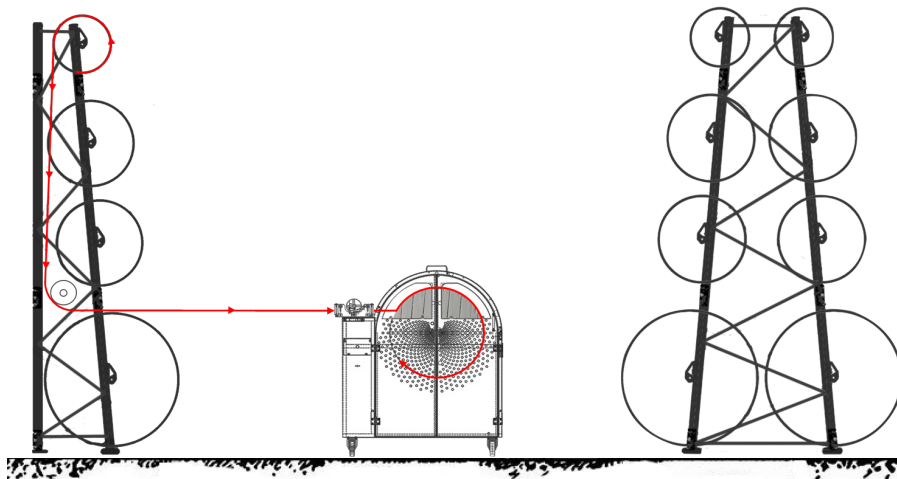

Dynamic cable drums' storage : the most efficient system for cables

Industry Distribution Logistics

- ☑ Time saving : each cable drum is on a shaft, ready to be unwound.
- ☑ Work comfort : simplified handling, ergonomics, safety.
- ☑ Space saving : highrack storage.
- ☑ Immediate visualization of stock.
- ☑ Can be completed by a mobile winding machine, a manual winder or simply a measuring device.
- ☑ Possibility to fix on the power supply socket of the mobile machine.



Technical features

Maximum load on a singlesided span: **4.350 kg**
 Maximum load on a doublesided span: **8.700 kg**

For drums:
 - maximum diameter: **1.400 mm**
 - maximum weight: **1.400 kg**

In 720 mm wide rows, maximum width of the drum : 640 mm
 In 920 mm wide rows, maximum width of the drum : 840 mm
 In 1220 mm wide rows, maximum width of the drum : 1040 mm

Depth of ladders at base
 - singlesided : 925 mm
 - doublesided : 1.609 mm

Width of rails : 80 mm

The ladders are composed of two rails.

Ladders: hot-rolled steel, hot-dip and continuous galvanizing.
 Shoes and shafts: steel, red epoxy dusting RAL 3020 + lateral protections and ladder foot protections.

Profiles: steel, blue powder coating RAL 5003.

These finishes prevent the rack from peeling and rusting due to the impacts to which it may be subjected, require no maintenance and ensure its durability.

Horizontal traction force of 600N.

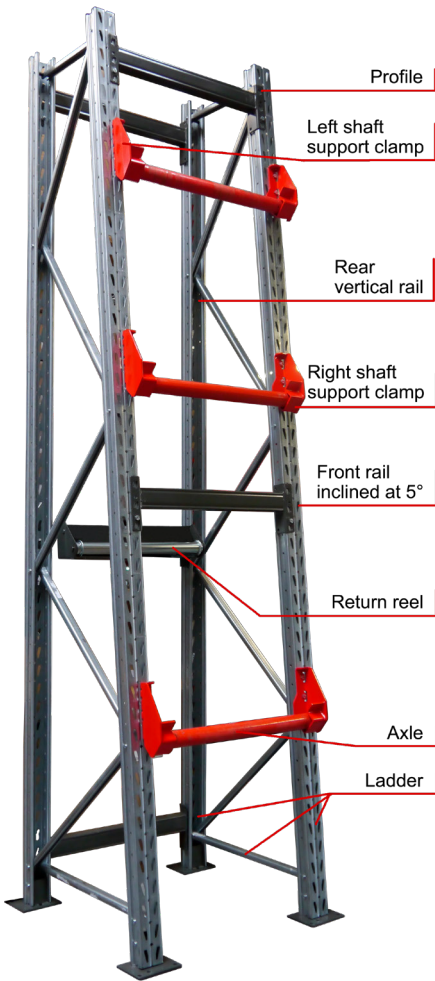

Safety first

Stability of the structure: front rails inclined 5° backward
 The heaviest cable drums should be stored at the bottom.

Special design of the shaft support clamps in order to avoid :

- shaft outlet
- the blocking of the cable drum against the ladders

Guide roller with flanges on each row

- to improve the distribution of tensile strength
- to prevent the escape of the cable drum
- adjustable height
- so that the cable enters horizontally, optimizing the precision of measurement.

A guide roller must be used : it must be possible to position all of the drums from the second level so that the cable can pass behind the guide roller.

Obligatory attachment to the ground, by mechanical pegs (double expansion cones) or chemical fixtures.

Adapter for forklift truck forks, essential for safe loading and unloading (made to measure).

Set up the cable drum rack : the width of the alleys must be sufficient for the manoeuvre and the loading.



CABLERACK® cable drum racks

Modular

Singlesided

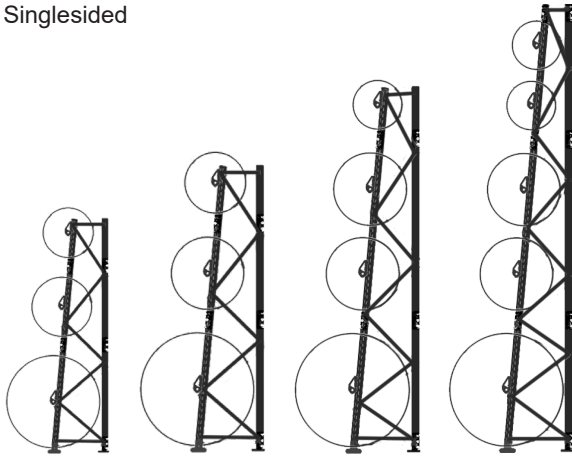

Doublesided

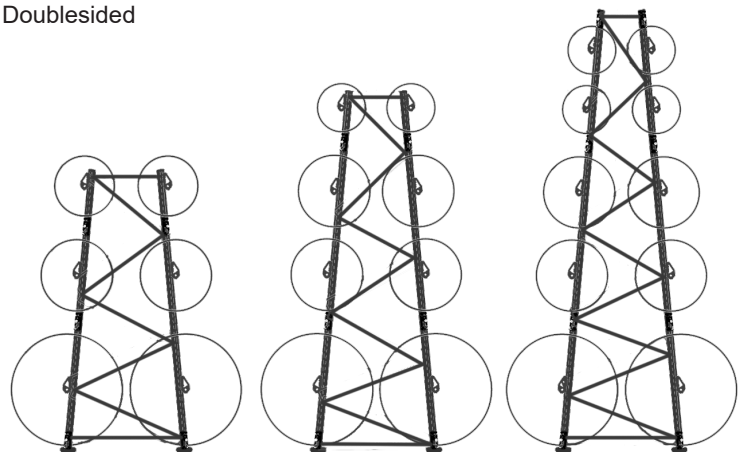

A rack is comprised of a starting row and the following rows.

4 standard heights :

- 2400 mm (3 levels of drums)
- 3500 mm (3 levels of drums)
- 4500mm (4 levels of drums)
- 5500 mm (5 levels of drums)

It is possible to order shafts and pairs of shoes to create additional levels (according to the diameter of the drums and without exceeding the load capacity per row).

3 standard span widths :

- 720 mm
- 920 mm
- 1220 mm

The spans of the 2 widths may be selected.

Individual shaft support shoes, adjustable separately (ladder rail holes positioned every 50 mm).

Shafts with a diameter of 34 mm or 60 mm, according to the diameter of the central hole of drums.

Special manufacture on request (for different heights, widths and loads).



	Height	Number of levels	Width between ladders	Span	Code
Single-sided	2400 mm	3	720 mm	Start	CR1F24307D
				Next	CR1F24307S
			920 mm	Start	CR1F24309D
				Next	CR1F24309S
			1220 mm	Start	CR1F24312D
				Next	CR1F24312S
	3500 mm	3	720 mm	Start	CR1F35307D
				Next	CR1F35307S
			920 mm	Start	CR1F35309D
				Next	CR1F35309S
			1220 mm	Start	CR1F35312D
				Next	CR1F35312S
	4500 mm	4	720 mm	Start	CR1F45407D
				Next	CR1F45407S
			920 mm	Start	CR1F45409D
Next				CR1F45409S	
1220 mm			Start	CR1F45412D	
			Next	CR1F45412S	
5500 mm	5	720 mm	Start	CR1F55507D	
			Next	CR1F55507S	
		920 mm	Start	CR1F55509D	
			Next	CR1F55509S	
		1220 mm	Start	CR1F55512D	
			Next	CR1F55512S	
Double-sided	3500 mm	3	720 mm	Start	CR2F35307D
				Next	CR2F35307S
			920 mm	Start	CR2F35309D
				Next	CR2F35309S
			1220 mm	Start	CR2F35312D
				Next	CR2F35312S
	4500 mm	4	720 mm	Start	CR2F45407D
				Next	CR2F45407S
			920 mm	Start	CR2F45409D
				Next	CR2F45409S
			1220 mm	Start	CR2F45412D
				Next	CR2F45412S
	5500 mm	5	720 mm	Start	CR2F55507D
				Next	CR2F55507S
			920 mm	Start	CR2F55509D
Next				CR2F55509S	
1220 mm			Start	CR2F55512D	
			Next	CR2F55512S	

CABLERACK® cable drum racks

Options



Shaft
+ shaft support clamps



Double guide roller
(for optic fiber)



Unwinding
pole

Options	Diameter	Length	Code
Supplementary shaft	34 mm	760 mm	CRAXE0760-34
		960 mm	CRAXE0960-34
	60 mm	760 mm	CRAXE0760-60
		960 mm	CRAXE0960-60
		1260 mm	CRAXE1260-60
Shaft support clamps (the pair)			CRSABOTS
Additional double guide roller (for fiber optic)			CROPT
Ladder foot protection			CRPROTP
Lateral protection	for singlesided rack		CRPROT1F
	for doublesided rack		CRPROT2F
Automatic rerollers 3G2.5 mm ²	H07RN-F - 10 meters		ER03025-10R-P325
	H07RN-F - 19 meters		ER03025-19R-P806
Adapter for forklift vehicle			RAB010
Unwinding pole			CRPERCHE



Ladder foot
protection

Lateral
protection



P325



P806

Unwinding pole

- To unroll drums which are stored in height, so as to bring the end of the cable to the guide roller.
- Telescopic storage pole 2x2m.
- In aluminium.

**Don't take the risk of climbing
over the rack or using a ladder**



**Work safely with
the unwinding pole**



CABLERACK® cable drum racks

Fork adapter

Indispensable for safely loading and unloading the cable drum rack.

NO



The cable drum at risk of falling.
The cable may be damaged.

YES

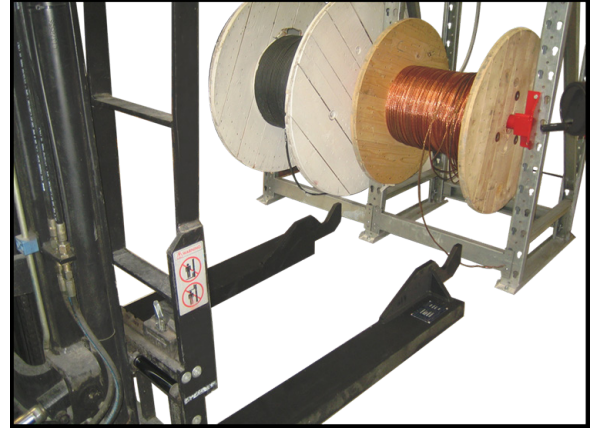

The cable drum is supported by a shaft.

The forklift truck must have:

- a sufficient lifting height
- sufficient distance between the forks with respect to the cable drum width
- sufficient loading capacity, taking into account the weight of the cable drums, the loading height and the shift in the center of gravity.

Nominal capacity: 1500 kg

Always lock the adapter with the system located at the rear of the forks.

Made to measure (fill in the questionnaire below).

Code RAB010



Forklift brand:

Year of manufacture:

Serial n°:

A =

B =

C =

D =

E =

F =

G =

H =

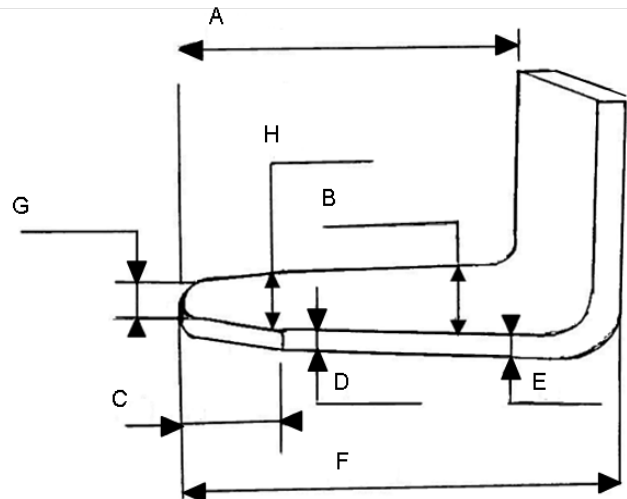

Document et photos non contractuels - 2021/201